

TREE NO.	BOTANICAL NAME	COMMON NAME	SIZE (DBH)	CONDITION	REMARKS
1	Acer saccharinum	Silver Maple	77	Fair	3 trunks with included bark remove for proposed building
2	Allanthurus altissima	Tree of Heaven	49	Good	remove for proposed building
3	Pinus nigra	Austrian Pine	42	Good	remove for proposed building
4	Pinus nigra	Austrian Pine	42	Good	remove for proposed building
5	Pinus nigra	Austrian Pine	41	Good	remove for proposed building
6	Pinus nigra	Austrian Pine	47	Good	remain
7	Pinus nigra	Austrian Pine	48	Good	remain
8	Pinus nigra	Austrian Pine	43	Good	remain
9	Pinus nigra	Austrian Pine	48	Good	remain
10	Pinus nigra	Austrian Pine	34	Good	remain
11	Pinus nigra	Austrian Pine	51	Good	remain
12	Picea pungens glauca	Colorado Blue Spruce	32	Poor	remove due to condition
13	Gleditsia triacanthos inermis	Honeylocust	59	Good	remain
14	Gleditsia triacanthos inermis	Honeylocust	49	Good	remain
15	Gleditsia triacanthos inermis	Honeylocust	50	Good	remain
16	Gleditsia triacanthos inermis	Honeylocust	48	Good	remain
17	Gleditsia triacanthos inermis	Honeylocust	47	Good	remain
18	Pinus nigra	Austrian Pine	39	Good	remain
19	Pinus nigra	Austrian Pine	36	Good	remain
20	Pinus nigra	Austrian Pine	50	Good	remain
21	Pinus nigra	Austrian Pine	42	Good	remain
22	Gleditsia triacanthos inermis	Honeylocust	55	Poor	remove due to condition
23	Gleditsia triacanthos inermis	Honeylocust	43	Good	remain
24	Gleditsia triacanthos inermis	Honeylocust	40	Good	remain
25	Gleditsia triacanthos inermis	Honeylocust	55	Good	remain
26	Fagus Sylvatica	European Beech	35	Good	remain
27	Acer planatoides "Crimson King"	Crimson King Norway Maple	29	Good	remain
28	Acer planatoides "Crimson King"	Crimson King Norway Maple	36	Good	remain

**Notes**

- The location of the existing trees was taken from the survey provided by Verhaegen Land Surveys.
- The species, size and condition of the existing trees was provided by Mr. Bill Roessel, Forester
- Care has been taken to obtain all information from reliable sources. All data has been verified insofar as possible. The consultant can neither guarantee nor be responsible for the accuracy of information provided by others.

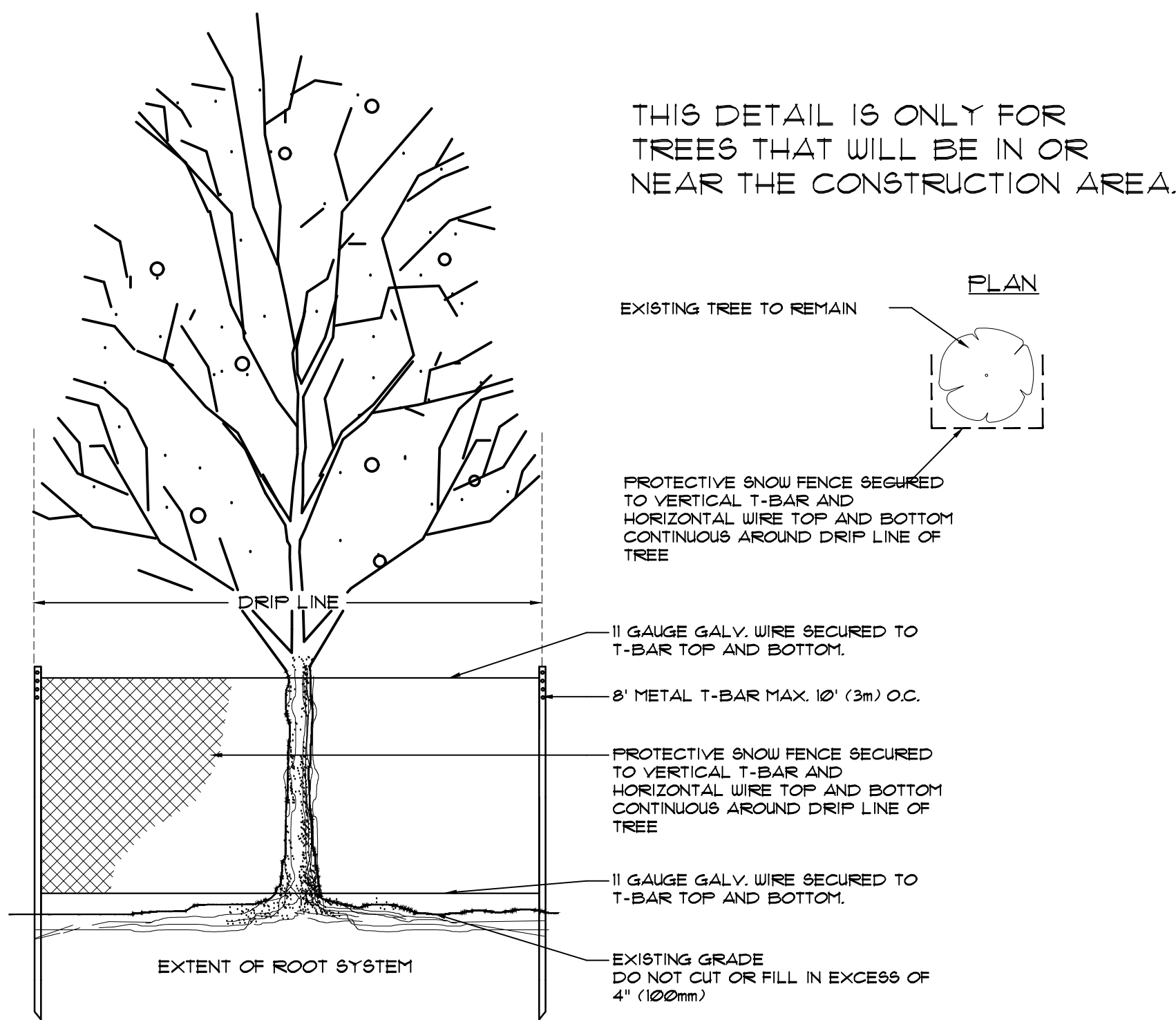

**Existing Tree Protection** NT6

**BP**  
Bezaire Partners  
Planners, Landscape Architects,  
Mediation, Public Consultation,  
Project Management  
302-180 Eugenie St. West  
Windsor, ON N8X 2X8  
p. 519.966.6844  
gbezaire@bezaire.ca

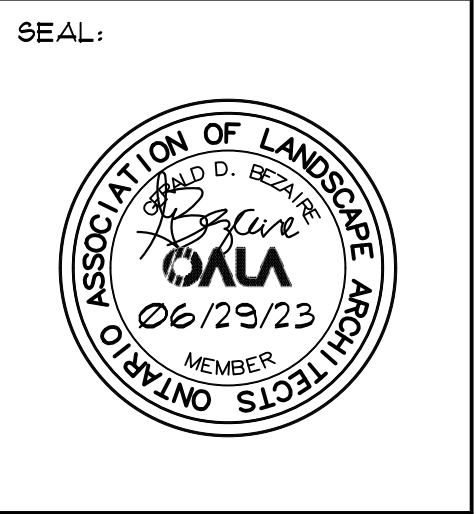

ISSUED:

REVISIONS:

All drawings, specifications and other related documents are the copyright property of the CONSULTANT and shall be returned upon request. Reproduction of drawings and related documents, in whole or in part, is forbidden without the written permission of the CONSULTANT. The contractor shall check and verify all pertinent dimensions and report any discrepancies to the CONSULTANT before proceeding with the work.

PROJECT:  
**APARTMENT FOR CABOTO CLUB**  
TECUMSEH ROAD  
WINDSOR, ONTARIO

DRAWING TITLE:  
**EXISTING TREE INVENTORY & PRESERVATION PLAN**

SCALE: AS NOTED  
DRAWN BY: GDB  
CHECKED BY: FLB  
APPROVED BY:  
DATE: JUNE 2023

DRAWING NO:  
**LA-1**  
CAD file: 1620 TIPP

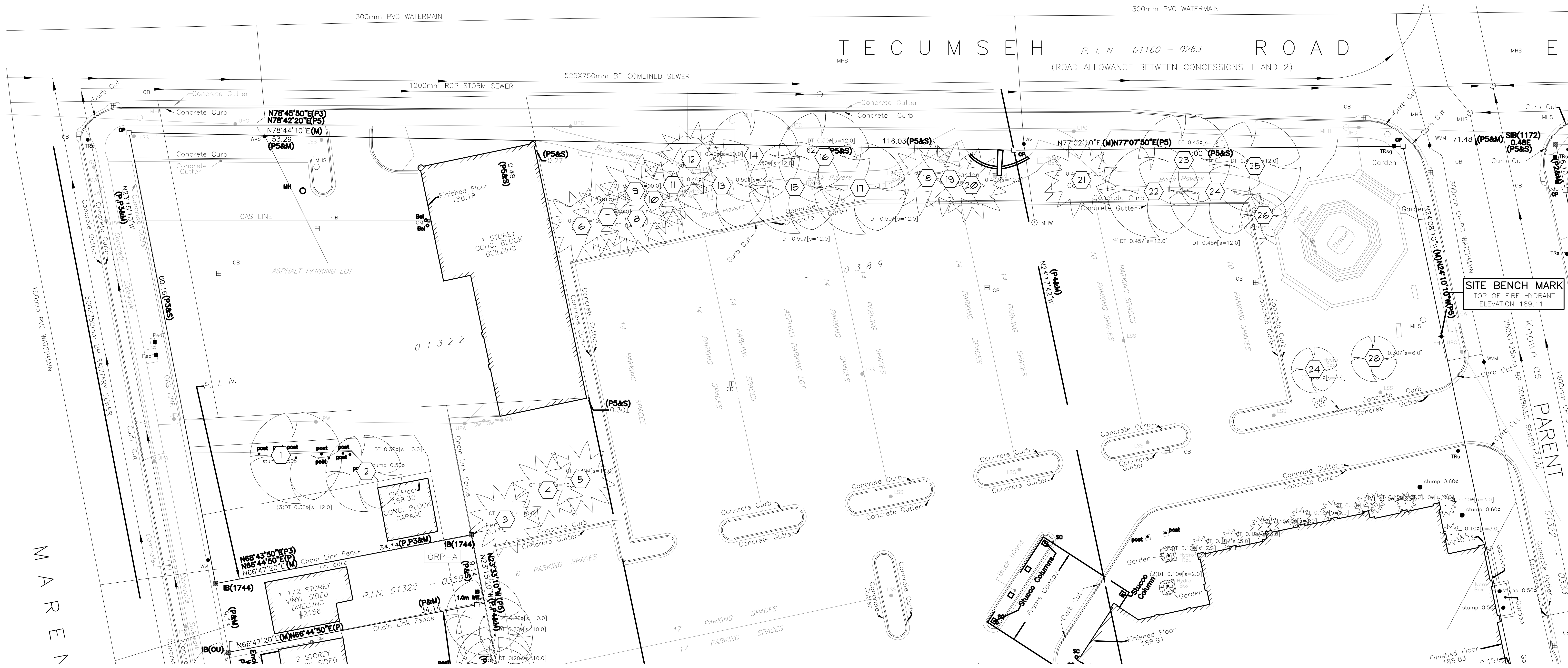

**EXISTING TREE INVENTORY & PRESERVATION PLAN**  
SCALE 1" = 20'-0"  
ORIGINAL SHEET SIZE: 30" x 42"

